

# PRODUCT SUBMITTAL

**WIRE-BOND**

## Series 200 Ladder Mesh ( For Single Wythe Wall)

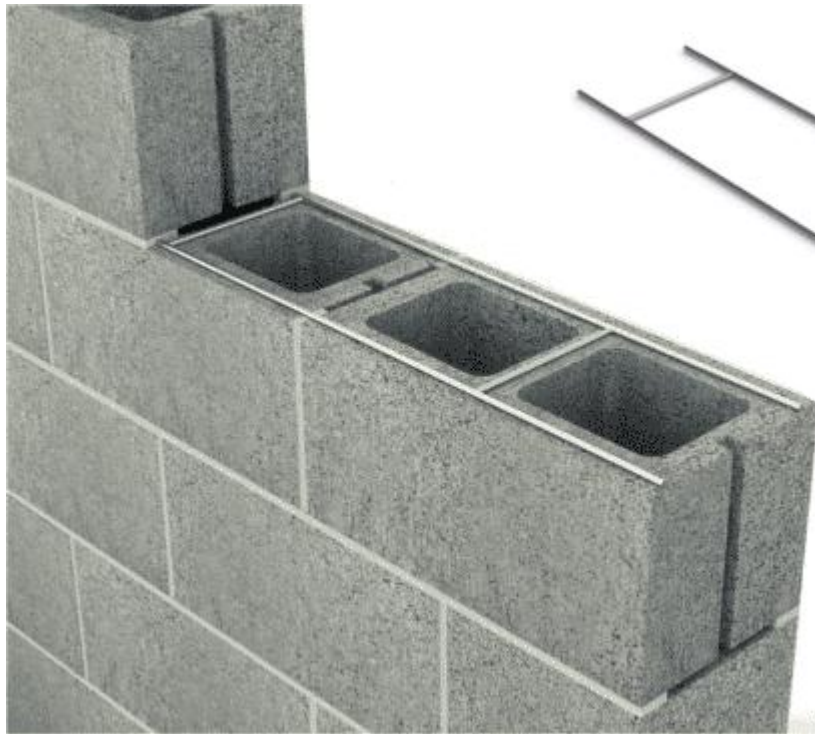

16" O.C. cross rods allow core clearance.

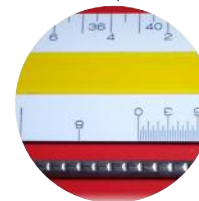
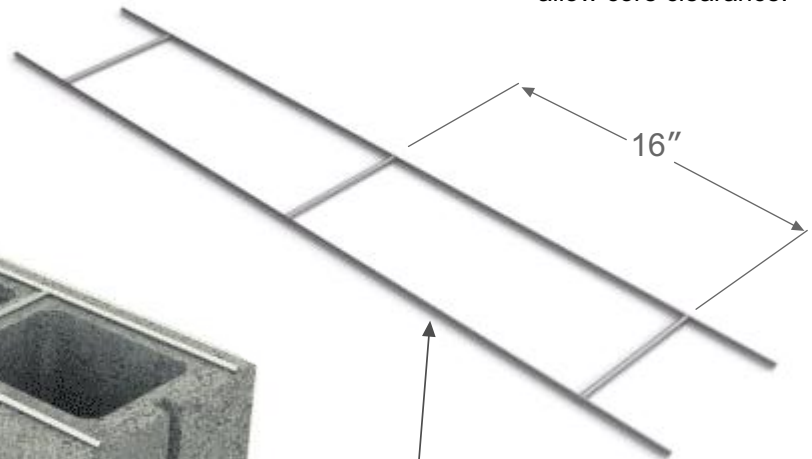

ASTM A 951  
Deformations  
8 sets/inch

MATERIAL CONFORMANCE	SIZES / FINISHES																		
<p>Wire (Carbon Steel): Prefabricated from cold-drawn steel wire conforming to <b>ASTM A1064/A1064M, ASTM A82/ A82M</b></p> <p>Tensile Strength - 80,000 p.s.i.   Yield Point - 70,000 p.s.i. minimum</p> <p><b>ASTM A951/A951M</b> (Standard Specification for Steel Wire for Masonry Joint Reinforcement)</p> <p><b>ACI / ASCE 530</b> (Building Code Requirements for Masonry Structures)</p> <p>Mill Galvanized coating: <b>ASTM A641/A641M (0.1 oz/ft)</b></p> <p>Hot-Dip Galvanized after fabrication: <b>ASTM A153/A153M-B2 (1.5 oz/ft)</b></p> <p>Wire (Stainless Steel): <b>ASTM A580/ASTM 580M - AISI</b> Type 304 (Type 316 available on special orders)</p>	<p><b>WIRE SIZE:</b></p> <table border="0"> <tr> <td>Standard</td> <td>9 Gauge (.148 in)</td> <td><b>CROSS RODS:</b></td> <td>9 Gauge</td> </tr> <tr> <td>Heavy Duty</td> <td>3/16 (.187 in)</td> <td></td> <td>9 Gauge</td> </tr> <tr> <td>Extra Heavy Duty</td> <td>3/16 (.187 in)</td> <td></td> <td>3/16</td> </tr> </table> <p>10' length standard, custom length available special order)</p>							Standard	9 Gauge (.148 in)	<b>CROSS RODS:</b>	9 Gauge	Heavy Duty	3/16 (.187 in)		9 Gauge	Extra Heavy Duty	3/16 (.187 in)		3/16
Standard	9 Gauge (.148 in)	<b>CROSS RODS:</b>	9 Gauge																
Heavy Duty	3/16 (.187 in)		9 Gauge																
Extra Heavy Duty	3/16 (.187 in)		3/16																
<p><b>Recycled Content:</b> Mill Galvanized &amp; Hot Dipped, 82.8% Post-Consumer 17% Post Industrial / Pre Consumer</p> <p><b>Stainless Steel</b> 97% Pre-Consumer V O C Content - 0%</p>	<p><b>CMU SIZE:</b></p> <table border="0"> <tr> <td>4"</td> <td>6"</td> <td>8"</td> <td>10"</td> <td>12"</td> <td>14"</td> <td>16"</td> </tr> </table> <p><b>FINISHES:</b></p> <table border="0"> <tr> <td>Mill Galvanized</td> <td>Hot Dip Galvanized</td> <td>Stainless Steel</td> </tr> </table>							4"	6"	8"	10"	12"	14"	16"	Mill Galvanized	Hot Dip Galvanized	Stainless Steel		
4"	6"	8"	10"	12"	14"	16"													
Mill Galvanized	Hot Dip Galvanized	Stainless Steel																	

Corporate Office: 400 Rountree Rd Charlotte, NC 28217  
TEL: (800) 849-6722 FAX: (704) 525-3761

Mailing Address: P.O. Box 240988 Charlotte, NC 28224



[www.wirebond.com](http://www.wirebond.com)

Memphis Plant: 2365 Harbor Ave. Memphis, TN 38113  
TEL: (800) 441-8359 FAX: (901) 775-9449

Mailing Address: P.O. Box 13124 Memphis, TN 38113