

PRODUCT SUBMITTAL

WIRE-BOND

Ladder Adjustable Double Loop Tie

- Loops extend one direction only to allow simple placement of insulation.
- Vertical style loops will not clog with mortar as construction progresses.
- Loops welded shut to maintain allowable tolerance and system integrity.

#1500-0 3/16" dia. Offset Rectangular Tie

3/16" dia. Loop Ties

3 point weld

1/16" maximum clearance meets code

Lock Washer

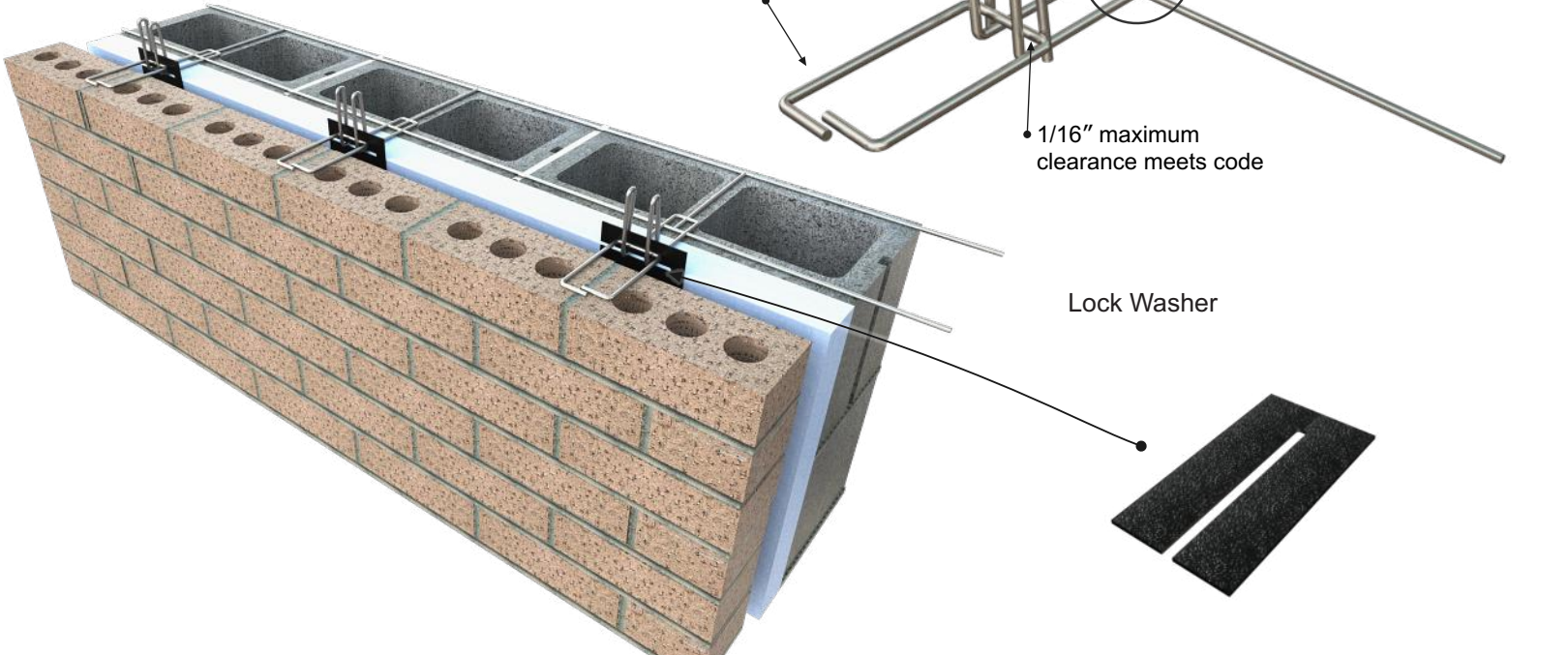

MATERIAL CONFORMANCE

Wire (Carbon Steel): Prefabricated from cold-drawn steel wire conforming to **ASTM A1064/A1064M, ASTM A82/ A82M**

Tensile Strength - 80,000 p.s.i. | Yield Point - 70,000 p.s.i. minimum

ASTM A951/A951M (Standard Specification for Steel Wire for Masonry Joint Reinforcement)

ACI / ASCE 530 (Building Code Requirements for Masonry Structures)

Mill Galvanized coating: **ASTM A641/A641M (0.1 oz/ft)**

Hot-Dip Galvanized after fabrication: **ASTM A153/A153M-B2 (1.5 oz/ft)**

Wire (Stainless Steel): **ASTM A580/ASTM 580M - AISI** Type 304 (Type 316 available on special orders)



Recycled Content:
Mill Galvanized & Pot Dipped,
82.8% Post-Consumer
17% Post Industrial / Pre Consumer

Stainless Steel
97% Pre-Consumer V O C Content - 0%

SIZES / FINISHES

WIRE SIZE:	SIDE RODS:	CROSS RODS:
Standard	9 Gauge (.148 in)	9 Gauge
Heavy Duty	3/16 (.187 in)	9 Gauge
Extra Heavy Duty	3/16 (.187 in)	3/16

CMU SIZE:	4"	6"	8"	10"	12"	14"	16"
#1500-0 Offset Rectangular Tie: 3/16" dia. standard							

Length:	3-1/4"	4-1/4"	5-1/4"	Other
FINISHES:	Hot Dip Galvanized	Stainless Steel		

*** Please state overall wall size and cavity or insulation when ordering*

Corporate Office: 400 Rountree Rd Charlotte, NC 28217
TEL: (800) 849-6722 FAX: (704) 525-3761

Mailing Address: P.O. Box 240988 Charlotte, NC 28224

WIRE-BOND

www.wirebond.com

Memphis Plant: 2365 Harbor Ave. Memphis, TN 38113
TEL: (800) 441-8359 FAX: (901) 775-9449

Mailing Address: P.O. Box 13124 Memphis, TN 38113