

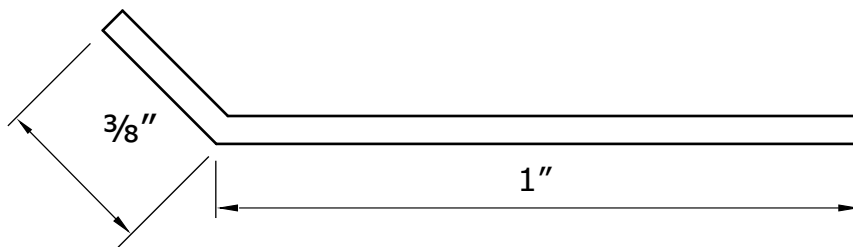

# PRODUCT SUBMITTAL

WIRE-BOND

## # 4210 Aluminum Termination Bar

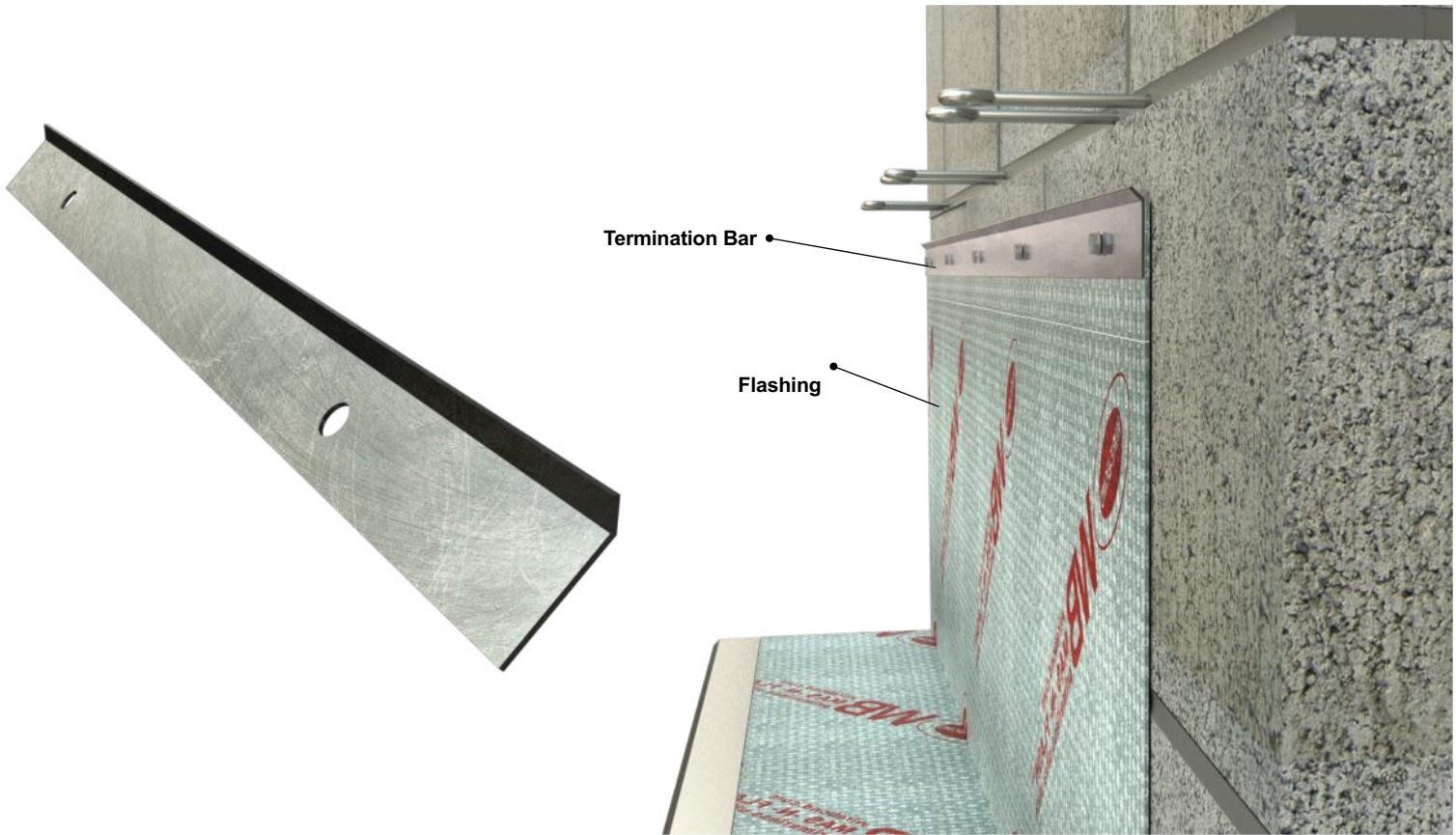

| MATERIAL CONFORMANCE  | SIZES / FINISHES  |
|---|---|
| <p><b>SHEET METAL:</b><br/>                     Aluminum: <b>ASTM B221 / ASTM B221M</b></p> <p><b>Steel Products (flats) Recycled Content:</b></p> <p>Aluminum      18% average (10% - 25% Range) Post Consumer<br/>                     56% average (25% - 75% Range) Pre Consumer</p> <p>V O C Content - 0%</p>  | <p><b>#4210 Aluminum Termination Bar:</b></p> <p>14 gauge x 1" wide x 3/8" sealant lip by 10' sections</p> <p>5/16" Slotted holes: 8" O.C.</p> <p>Aluminum: <b>ASTM B221 / ASTM B221M</b></p> |

**Corporate Office:** 400 Rountree Rd Charlotte, NC 28217  
 TEL: (800) 849-6722 FAX: (704) 525-3761

**Mailing Address:** P.O. Box 240988 Charlotte, NC 28224



[www.wirebond.com](http://www.wirebond.com)

**Memphis Plant:** 2365 Harbor Ave. Memphis, TN 38113  
 TEL: (800) 441-8359 FAX: (901) 775-9449

**Mailing Address:** P.O. Box 13124 Memphis, TN 38113