

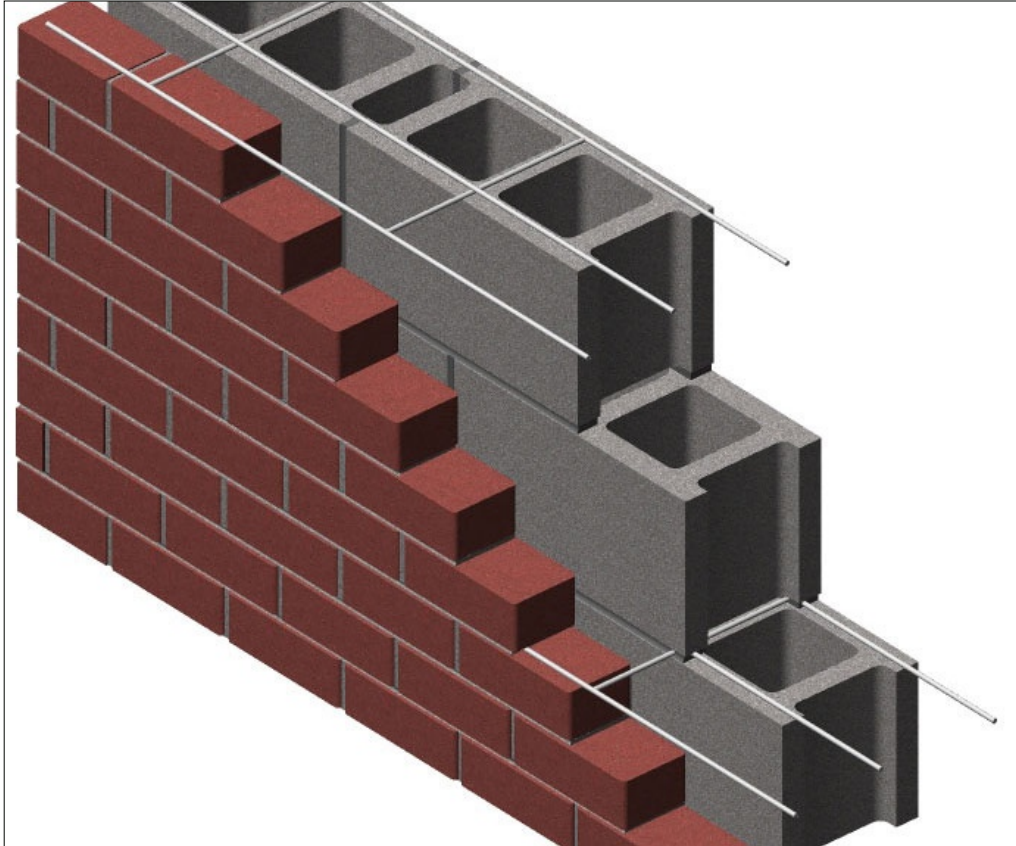

PRODUCT SUBMITTAL



Series 200 Ladder Mesh (3 Wire System)



16" O.C. cross rods allow core clearance.

MATERIAL CONFORMANCE		SIZES / FINISHES						
<p>ASTM A82 / A82M - (Cold drawn steel wire) Tensile Strength - 80,000 psi Yield Point - 70,000 psi</p> <p>ASTM A951 / A951M-06 - (Standard Specification for Steel Wire for Masonry Joint Reinforcement)</p> <p>ACI / ASCE 530 - (Building code requirements for masonry structures Mill Galvanized / Zinc Coating: ASTM A641 / A641M (0.10 Oz per sq ft) Hot Dip Galvanized after fabrication / Zinc Coating: ASTM A153 / A153M-B2 (1.50 oz per sq ft) Stainless Steel ASTM 580 / 580M Type 304 (Type 316 available on special orders)</p> <p>Recycled Content: Mill Galvanized & Hot Dipped, 82.8% Post-Consumer 17% Post Industrial / Pre-Consumer,</p> <p>Stainless Steel, 97% Pre-Consumer V O C Content - 0%</p> 		<p>WIRE SIZE:</p> <p>Standard Heavy Duty Extra Heavy Duty</p>		<p>Side Rods</p> <p>9 Gauge (.148 in) 3/16" (.187 in) 3/16" (.187 in)</p>		<p>Cross Rods</p> <p>9 Gauge 9 Gauge 3/16"</p>		
		<p>CMU SIZE:</p> <p>4" 6" 8" 10" 12" 14" 16" F_i "</p>						
		<p>FINISHES:</p> <p>Mill Galvanized Hot Dip Galvanized Stainless Steel</p>						
		<p>Please state overall wall size when ordering</p>						

Corporate Office: 400 Rountree Rd Charlotte, NC 28217
 TEL: (800) 849-6722 FAX: (704) 525-3761
 Mailing Address: P.O. Box 240988 Charlotte, NC 28224



Memphis Plant: 2365 Harbor Ave. Memphis, TN 38113
 TEL: (800) 441-8359 FAX: (901) 775-9449
 Mailing Address: P.O. Box 13124 Memphis, TN 38113